



Friday 11 March - Sunday 13 March 2022
Adelaide Hills Convention Centre
Hahndorf, South Australia



The SA organising team and families welcome you to South Australia

FREE - Registration and attendance

- Meals – morning and afternoon tea, lunch, and dinner (excludes breakfast and drinks)
- Conference “Building a good life” **OR** Excursion to Monarto Safari Park
- Disco Saturday night
- Hahndorf Farm Barn animal petting on Sunday morning

Accommodation

Accommodation at Hahndorf Resort [<https://hahndorfresort.com.au>] is to be booked and paid for by families. Please contact the venue on 08 8388 7921, quoting "Cri du Chat Support Group"

- Two Adults per night = \$169
- Extra Adult per night = \$25
- Child per night = \$10 (3 – 14 years old)
- Infant = free of charge (2 years and under)

Additional Information

- Special rates are available from Thursday to Sunday nights inclusive until Friday 7 January 2022 (accommodation is open to the general public after this date).
- Monday 14 March 2022 is a public holiday in South Australia.
- Cancellations due to Covid-19:
- Family Weekend - 100% refund 5 days prior to event
- Accommodation - Full refund less \$25 booking fee **OR** transfer of booking to any Discovery Park in Australia – valid for 12 months
- The weekend is subject to government health regulations at the time.
- Families experiencing financial hardship are urged to contact the Committee
- Families are requested to bring their own support team where possible
- Please contact Carol Neal from the SA organising team with any queries on conference2022@criduchat.org.au

We hope you will enjoy the weekend and extend your stay to enjoy the internationally renowned WOMADelaide and the Adelaide Hills.

Program of Events (subject to change)

Friday 11 March - check in from 2pm

- Welcome drinks * from 5.00pm and BBQ dinner
- Evening entertainment

Saturday 12 March

- Conference and workshops 'Building a good life' (10.00am to 4.00pm) **or**
- Excursion to Monarto Safari Park (10.00am - 4.00pm)
- Happy Hour * drinks from 5pm and Dinner at 6.00pm
- Disco and live band in the evening

Sunday 13 March

- Hahndorf Farm Barn and animal petting from 10.00am to 12.00 noon
- Lunch and farewells

* Drinks can be purchased at the bar (corkage fees apply for BYO)

Please note: Registration closes on Friday 7 January 2022 and accommodation is open to the general public after this date. Book NOW!!

- Studio Units
- Self Contained Lakeview Family Cottage
- Family Cottages
- Cottages
- Self Contained Unit Disabled/Limited Mobility
- Resort Rooms
- Lakeview Units
- Spa Units
- 2 Bedroom Units
- Resort House/Lakeview House
- Drive Through Caravan Sites
- Caravan Sites
- Assembly Points
- Amenities
- Function Centres



**145a Mt Barker Road
Hahndorf, South Australia 5245**

←← TO HAHNDORF

TO ADELAIDE →→

DISCOVERY HAHNDORF RESORT

Accommodation Sheet

(03) 8388 7921 | hahndorf@discoveryparks.com.au

Cottages

- Sleeps 2
- Open Plan
- 1 Queen bed
- En-suite bathroom with vanity, shower, toilet, hair dryer
- Microwave, toaster, kettle, bar fridge, crockery, cutlery, glasses, sink
- Reverse cycle air conditioning
- All linen provided
- Electric blankets
- Dining table & chairs
- Flat screen TV
- Free Wi-Fi
- Iron & ironing board
- Welcome tea, coffee, sugar, milk, shampoo & soap
- Outdoor setting
- Serviced daily
- Car park

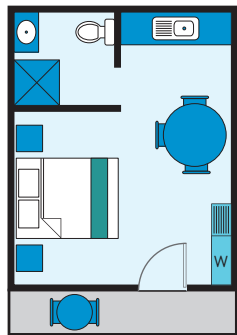

Cottages
Rate: 2 persons
From \$140

Cottages

- Sleeps 3
- Open Plan
- 1 Queen bed & 1 single bed
- En-suite bathroom with vanity, shower, toilet, hair dryer
- Microwave, toaster, kettle, bar fridge, crockery, cutlery, glasses, sink
- Reverse cycle air conditioning
- All linen provided
- Electric blankets
- Dining table & chairs
- Flat screen TV
- Free Wi-Fi
- Iron & ironing board
- Welcome tea, coffee, sugar, milk, shampoo & soap
- Outdoor setting
- Serviced daily
- Car park

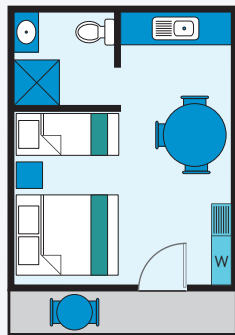

Cottages
Rate: 2 persons
From \$140
Extra Guest (Aged 2 & over) - \$25 each

Resort Rooms

- Sleeps 2 adults (no children allowed)
- Open Plan
- 1 Queen bed
- En-suite bathroom with vanity, shower, toilet, hair dryer
- Kettle, bar fridge, mugs, glasses
- Reverse cycle air conditioning
- All linen provided
- Electric blankets
- Flat screen TV
- Free Wi-Fi
- Iron & ironing board
- Welcome tea, coffee, sugar, milk, shampoo & soap
- Serviced daily
- Car park

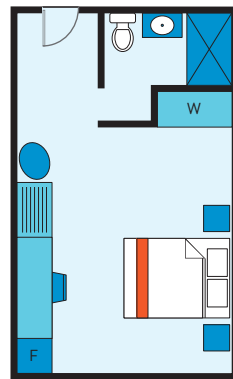

Resort Rooms
Rate: 2 persons
From \$165

Resort Rooms

- Sleeps 2 adults (no children allowed)
- Open Plan
- 2 Queen beds
- En-suite bathroom with vanity, shower, toilet, hair dryer
- Kettle, bar fridge, mugs, glasses
- Reverse cycle air conditioning
- All linen provided
- Electric blankets
- Flat screen TV
- Free Wi-Fi
- Iron & ironing board
- Welcome tea, coffee, sugar, milk, shampoo & soap
- Serviced daily
- Car park

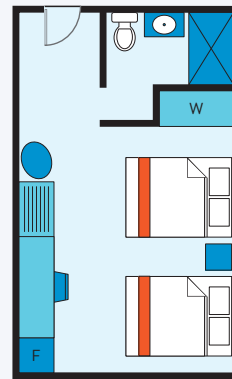

Resort Rooms
Rate: 2 persons
From \$165
Extra Adult - \$25 each

Lakeview Units

- Sleeps 2
- 1 bedroom
- 1 Queen bed
- En-suite bathroom with toilet, shower, vanity, hair dryer (no bath)
- Separate living area with dining table, chairs & couch
- Microwave, toaster, kettle, bar fridge, crockery, cutlery, glasses, sink
- Reverse cycle air conditioning
- All linen provided
- Electric blankets
- Flat screen TV
- Free Wi-Fi
- Iron & ironing board
- Welcome tea, coffee, sugar, milk, shampoo & soap
- Outdoor setting
- Serviced daily
- Car park

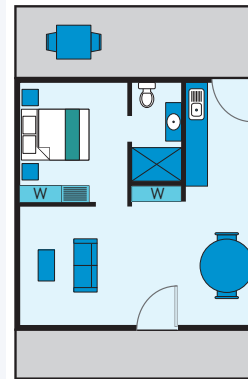

Lakeview Units
Rate: 2 persons
From \$165

2 Bedroom Units

- Sleeps 4
- 2 bedrooms
- 1 Queen bed & 2 singles beds
- Bathroom with vanity, shower, toilet, hair dryer
- Separate living area with dining table, chairs & couch
- Microwave, toaster, kettle, bar fridge, crockery, cutlery, glasses, sink
- Reverse cycle air conditioning
- All linen provided
- Electric blankets
- Flat screen TV
- Free Wi-Fi
- Iron & ironing board
- Welcome tea, coffee, sugar, milk, shampoo & soap
- Outdoor setting
- Serviced daily
- Car park

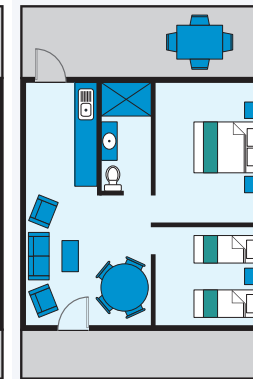

Two Bedroom Units
Rate: 2 persons
From \$165
Extra Guest (Aged 2 & over) - \$25 each

2 Bedroom Units

- Sleeps 4
- 2 bedrooms
- 2 Queen beds
- Bathroom with vanity, shower, toilet, hair dryer
- Separate living area with dining table, chairs & couch
- Microwave, toaster, kettle, bar fridge, crockery, cutlery, glasses, sink
- Reverse cycle air conditioning
- All linen provided
- Electric blankets
- Flat screen TV
- Free Wi-Fi
- Iron & ironing board
- Welcome tea, coffee, sugar, milk, shampoo & soap
- Outdoor setting
- Serviced daily
- Car park

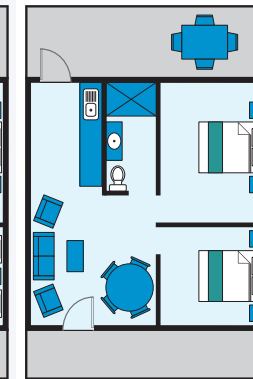

Two Bedroom Units
Rate: 2 persons
From \$165
Extra Guest (Aged 2 & over) - \$25 each

2 Bedroom Spa Units

- Sleeps 4 adults (no children allowed)
- 2 bedrooms
- 2 Queen beds
- Two way bathroom with shower & separate spa, toilet, vanity, hair dryer
- Dining table and chairs & couch in living area
- Microwave, toaster, kettle, bar fridge, crockery, cutlery, glasses, sink
- Reverse cycle air conditioning
- All linen provided
- Electric blankets
- Flat screen TV
- Free Wi-Fi
- Iron & ironing board
- Welcome tea, coffee, sugar, milk, shampoo & soap
- Outdoor setting
- Serviced daily
- Car park

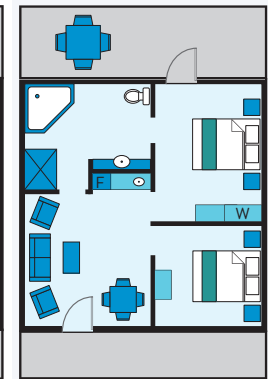

2 Bedroom Spa Units
Rate: 2 persons
From \$190
Extra Adult - \$25 each

DISCOVERY HAHNDORF RESORT

Accommodation Sheet

(03) 8388 7921 | hahndorf@discoveryparks.com.au

Limited Mobility Unit

- Sleeps 2
- 1 bedroom
- Self-contained
- 1 Queen bed
- En-suite bathroom with vanity, shower, toilet, hair dryer
- Cooktop, oven, dishwasher, microwave, toaster, kettle, bar fridge, crockery, cutlery, glasses, sink
- Reverse cycle air conditioning
- All linen provided
- Electric blankets
- Dining table and chairs
- Flat screen TV
- Free Wi-Fi
- Iron & ironing board
- Welcome tea, coffee, sugar, milk shampoo & soap
- Outdoor setting
- Serviced daily
- Car park

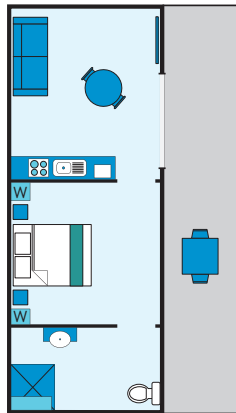

Limited Mobility Unit

Rate: 2 persons
From \$175

Limited Mobility Unit

- Sleeps 4
- 2 bedrooms
- Self-contained
- 2 Queen beds
- En-suite bathroom with vanity, shower, toilet, hair dryer
- Cooktop, oven, dishwasher, microwave, toaster, kettle, bar fridge, crockery, cutlery, glasses, sink
- Reverse cycle air conditioning
- All linen provided
- Electric blankets
- Dining table & chairs
- Flat screen TV
- Free Wi-Fi
- Iron & ironing board
- Welcome tea, coffee, sugar, milk, shampoo & soap
- Outdoor setting
- Serviced daily
- Car park

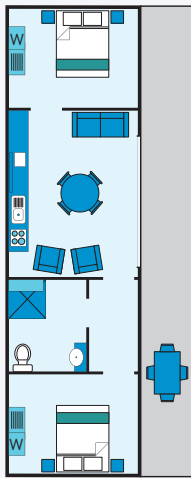

Limited Mobility Unit

Rate: 2 persons
From \$175
Extra Guest (Aged 2 & over)
- \$25 each

Family Cottage

- Sleeps 6
- 2 bedrooms
- 1 Queen bed, 2 singles & 1 set of bunk beds
- En-suite bathroom with vanity, shower, toilet, hair dryer
- Cooktop, microwave, toaster, kettle, large fridge, crockery, cutlery, glasses, sink
- Reverse cycle air conditioning
- All linen provided
- Electric blankets (excluding bunks)
- Flat screen TV
- Free Wi-Fi
- Iron & ironing board
- Welcome tea, coffee, sugar, milk, shampoo & soap
- Outdoor setting
- Serviced daily
- Car park

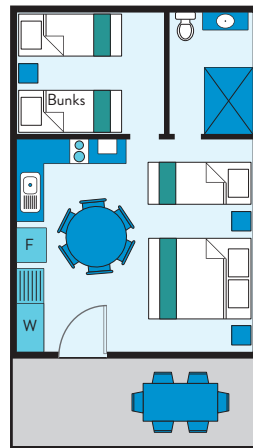

Family Cottage

Rate: 2 persons
From \$165
Extra Guest (Aged 2 & over)
- \$25 each

Lakeview Family Cottages

Minimum 2 night stay

- Sleeps 6
- 2 bedrooms
- Self-contained
- 1 Queen bed & 2 sets of bunk beds
- 1 Bathroom with shower, vanity, hair dryer
- Separate living area with dining table, chairs and lounges
- Full kitchen facilities – dishwasher, oven, cooktop, microwave, kettle, fridge, crockery, cutlery, glasses, sink
- Reverse cycle air conditioning
- All linen provided
- Electric blankets (excluding bunks)
- Flat screen TV
- Iron and Ironing Board
- Welcome tea, coffee, sugar, milk, shampoo & soap
- Outdoor setting
- Serviced daily
- Car park

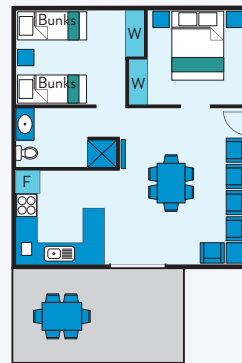

Lakeview Family Cottages

Rate: 2 persons
From \$195
Extra Guest (Aged 2 & over)
- \$25 each

Lakeview Family Cottages

Minimum 2 night stay

- Sleeps 8
- 3 bedrooms
- Self-contained
- 2 Queen beds & 2 sets of bunk beds
- 2 Bathrooms with shower, vanity, hair dryer
- Separate living area with dining table, chairs and lounges
- Full kitchen facilities – dishwasher, oven, cooktop, microwave, kettle, fridge, crockery, cutlery, glasses, sink
- Reverse cycle air conditioning
- All linen provided
- Electric blankets (excluding bunks)
- Flat screen TV
- Iron and Ironing Board
- Welcome tea, coffee, sugar, milk, shampoo & soap
- Outdoor setting
- Serviced daily
- Car park

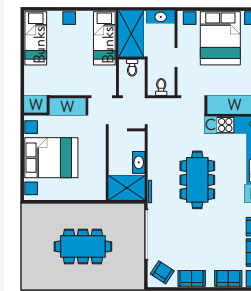

Lakeview Family Cottages

Rate: 2 persons
From \$225
Extra Guest (Aged 2 & over)
- \$25 each

Resort House

Minimum 2 night stay

- Sleeps 8
- 3 bedrooms
- Self-contained
- 2 Queen & 2 sets of bunk beds
- Bathroom with bath, shower, vanity, hair dryer
- Separate toilet
- Separate living area with dining table, chairs & 2 lounges
- Full kitchen facilities – dishwasher, oven, cooktop, microwave, toaster, kettle, large fridge, crockery, cutlery, glasses, sink
- Reverse cycle air conditioning
- All linen provided
- Electric blankets (excluding bunks)
- Flat screen TV
- Free Wi-Fi
- Iron & ironing board
- Welcome tea, coffee, sugar, milk, shampoo & soap
- Outdoor setting
- Serviced daily
- Car park

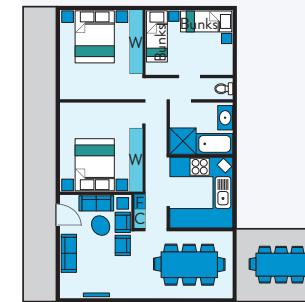

Resort House

Rate: 2 persons
From \$225
Extra Guest (Aged 2 & over)
- \$25 each

Lakeview House

Minimum 2 night stay

- Sleeps 10
- 3 bedrooms
- Self-contained
- 3 bedrooms
- 3 Queen & 2 sets of bunk beds
- 2 Bathrooms (no bath) with shower, vanity, hair dryer
- Separate living area with dining table, chairs & 2 lounges
- Full kitchen facilities – dishwasher, oven, cooktop, microwave, toaster, kettle, large fridge, crockery, cutlery, glasses, sink
- Reverse cycle air conditioning
- All linen provided
- Electric blankets (excluding bunks)
- Flat screen TV
- Free Wi-Fi
- Iron & ironing board
- Welcome tea, coffee, sugar, milk, shampoo & soap
- Outdoor setting
- Serviced daily
- Car park

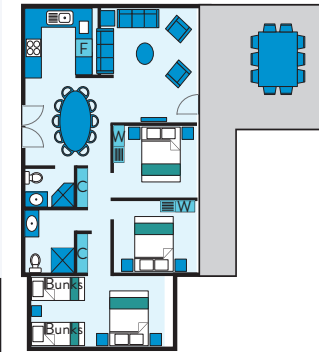

Lakeview House

Rate: 2 persons
From \$225
Extra Guest (Aged 2 & over)
- \$25 each